

- 1** M8, M10 & M12 bolts available as alternatives
- depending on clamping force requirements
- 2** Clamp band in one piece
- contact surface meets pipe consistently
- even contact pressure over the entire pipe circumference
- excellent sealing properties
- 3** Single-bolt closure
- easy installation
- 4** Rounded band edges
- pipe protection
- prevents risk of injuries

Exhaust pipe clamps

NORMACONNECT® ARS exhaust pipe clamps provide a secure, reliable connection for pipes that are fitted into one another, even those that are subject to significant temperature fluctuations. As such, they are particularly suitable for connecting exhaust pipes and silencers in the automotive industry.



Advantages at a glance

- ✓ One piece
- ✓ Contact surface meets pipe consistently
- ✓ Even contact pressure over entire pipe circumference
- ✓ No risk of asymmetrical pipe deformation

Applications

- Agricultural machines
- Building machines
- Engine manufacturing

Materials

W1	W2	W3	W4	W5
x	x*		x*	x*

* On request.

Material	Corrosion resistance in salt spray testing
W1	Min. 144 h

Bolts

Bolt	Hammer head bolt/Flange nut	Hexagon-head bolt/Flange nut	Hexagon-head bolt/Hexagon	Loose washer*
M8	x	x		x**
M10			x	x
M12			x	x

* Under bolt head and under bolt nut.

** Under bolt head (select nominal diameters only).

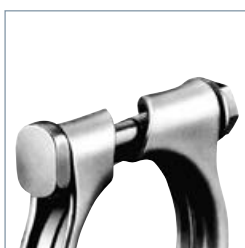

M8 version with hammer head bolt.

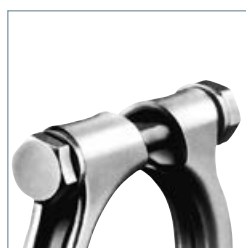
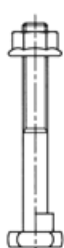

M10 and M12 version with hexagon-head bolt.

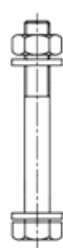

Technical data & Ordering information

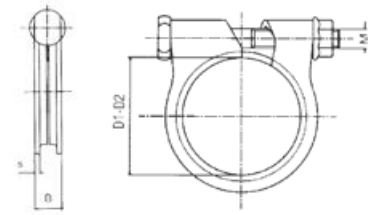

NORMACONNECT®

NORMACONNECT® ARS					
Designation	Clamping ranges D1-D2 in mm	S	B	Recommended tightening torque	W1 Product No.
ARS-M8-27	24-27	1.5	10.4	8 – 10 Nm	0151 8939 027
ARS-M8-33	30-33	1.5	10.4		0151 8939 033
ARS-M8-36	33-36	2.0	12.8	10 – 15 Nm	0151 8940 036
ARS-M8-39.5	36.5-39.5	2.0	12.0		0151 8940 040
ARS-M8-42	39-42	2.0	12.8		0151 8940 042
ARS-M8-45	42-45	2.5	13.6	15 – 20 Nm	0151 8941 045
ARS-M8-46	43-46	2.5	12.8		0151 8941 046
ARS-M8-47	44-47	2.5	13.6		0151 8941 047
ARS-M8-48	45-49	2.5	13.2		0151 8941 048
ARS-M8-49	45-49	2.5	13.2		0151 8941 049
ARS-M8-50.5	51-54	2.5	13.2		0151 8941 505
ARS-M8-51	48-51	2.5	13.2		0151 8941 051
ARS-M8-54	51-54	2.5	13.2		0151 8941 054
ARS-M8-55	52-55	2.5	13.6		0151 8941 055
ARS-M8-58	55-58	2.5	13.2		0151 8941 058
ARS-M8-64	61-64	2.5	13.2		0151 8941 064
ARS-M8-66	63-66	2.5	13.2	0151 8941 066	
ARS-M8-71	68-71	2.5	13.2	0151 8941 071	